

# Plastic Containers and Packaging

Collection days  
Once a Week

Collection Area  
Clean Station

Disposal Method  
Fully transparent bag  
(15~45ℓ)

Attention  mark

Plastic containers and packaging fall under this category.  
Plastic Products (like plastic **buckets**) on the other hand, do not.

## Please clean plastic items before disposal!

The following illustration has **examples** of items in the "plastic" category.



## Please don't use two bags at once.

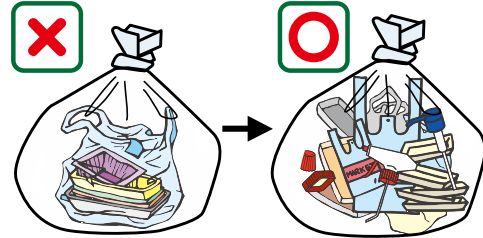

If you do this, we can't efficiently collect and separate trash.

## Things that are easy to confuse.

Plastic containers and Packaging

Paper containers (Burnable Trash)



Tray Containers and Styrofoam also fall under this category.

- You don't need to remove **labels and seals**.
- We don't mind if you use **supermarket bags** to put kitchen garbage in, but please put all unused bags with "Pla" .
- We can't recycle **dirty plastic**. Therefore, dirty plastic falls under "Burnable Trash" .
- **Wraps** that were used for fresh food, fall under "Burnable trash" despite a  mark.

Things that don't fall under this category.  
( Example )

Even though the items below are plastic, they fall under "Burnable trash", so please be careful. (See page 8)



Plastic containers and Packaging